



Windows 10 – how to check Internet data usage

Click **Start**  > **Settings**  > **Network & internet**, then click **Data usage**



You see the following screen displaying total usage. Click **View usage details**

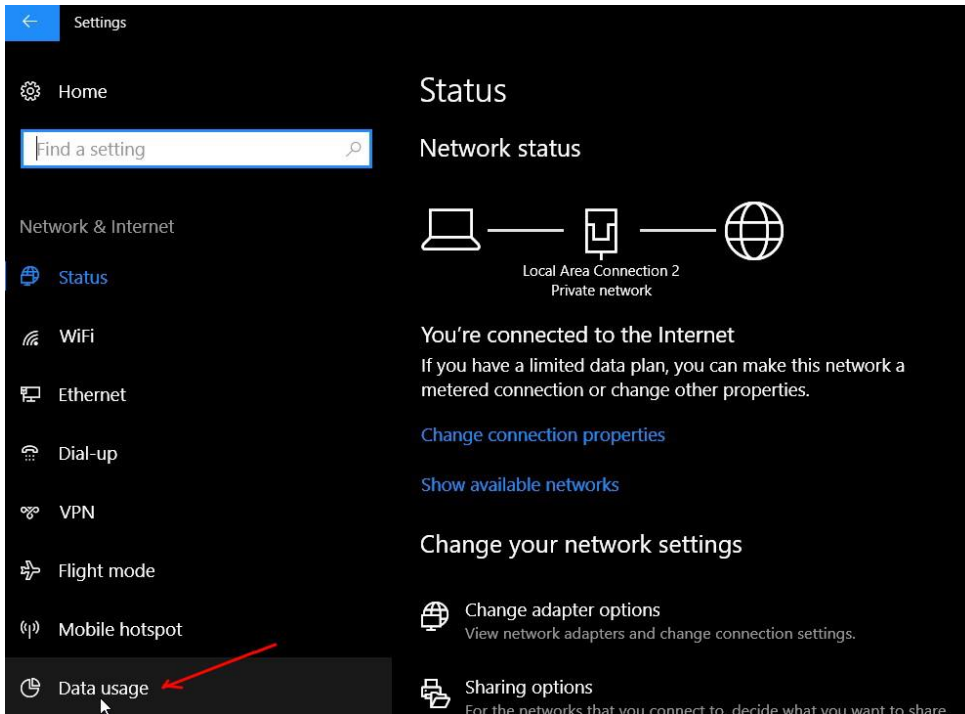
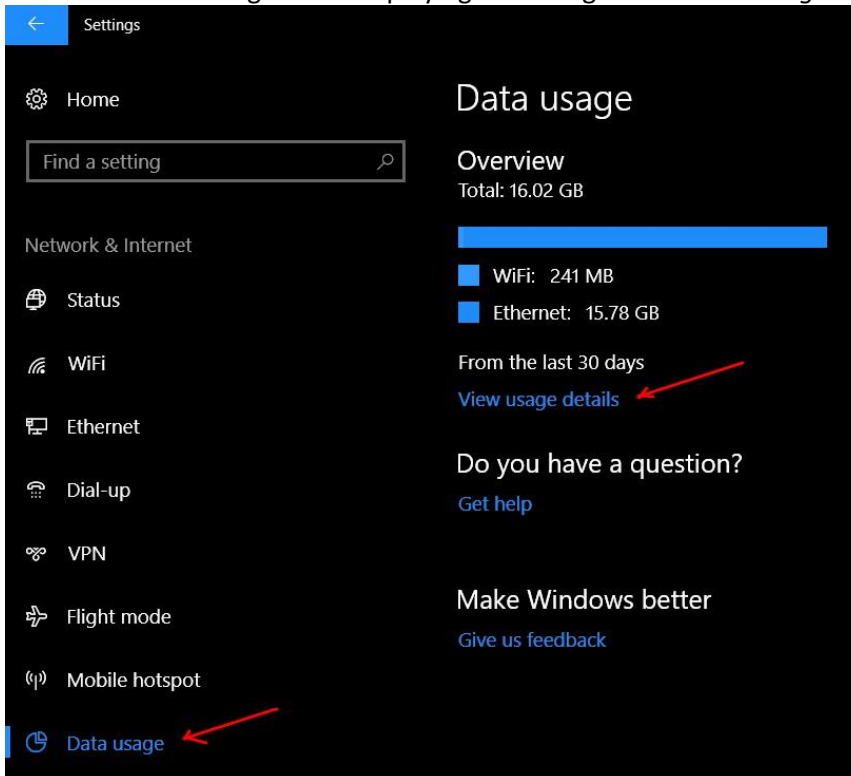

This screen shows the usage of all the apps using WiFi, have a look at who is the using all your internet data

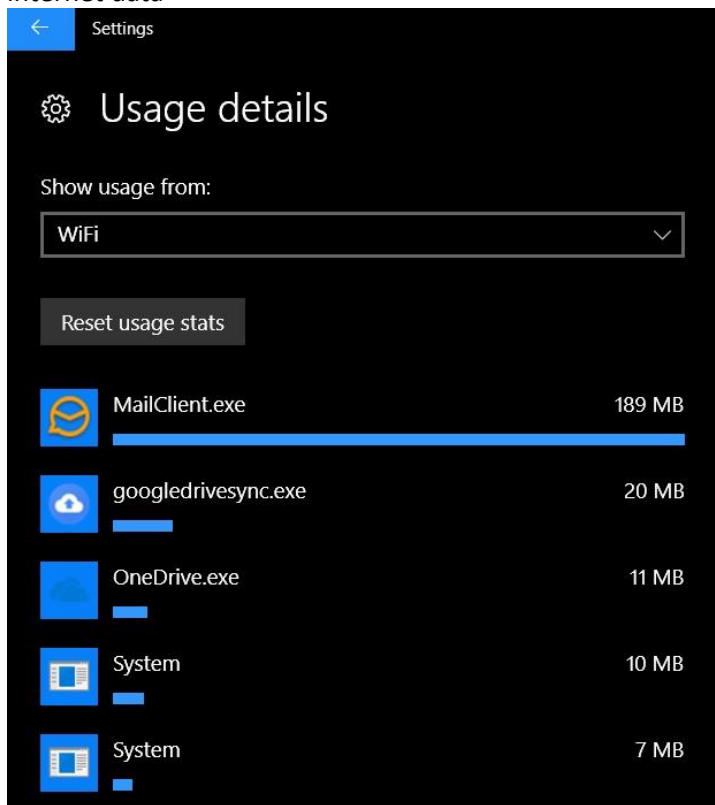

If you connect the computer by Ethernet cable, you can also see usage there. Click on the Show usage from: box and choose Ethernet

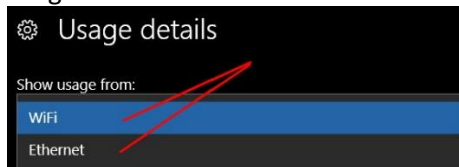

Then it shows Ethernet usage

